



High Pressure Chemical Injector
Operating and Maintenance Instructions



Product No 109-0009

Fitting the Couplings

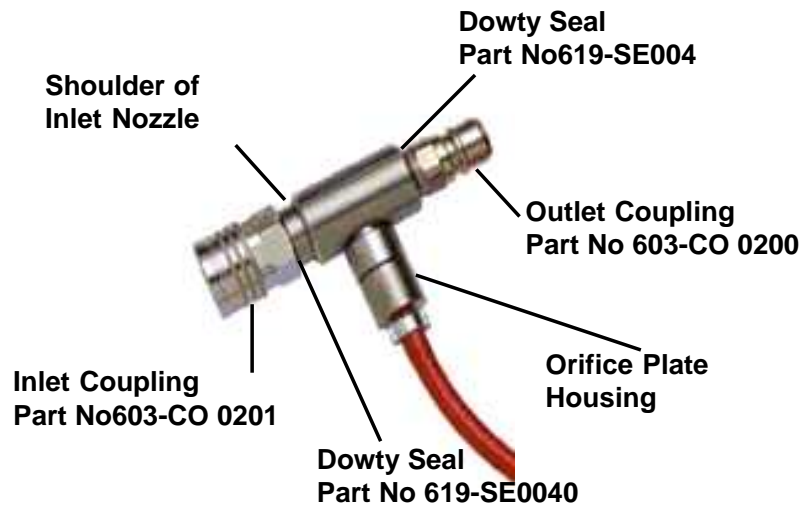

Fixed Orifice Metering Valve Changing The Orifice Plate

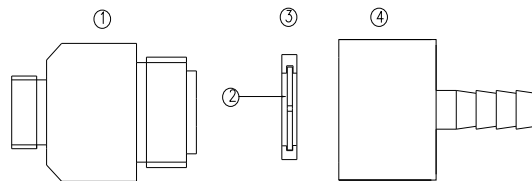

Unscrew the hose tail nut(4) from the Body(1)

Remove the Seal(3) and Orifice plate(2) assembly from inside the Hose tail nut.

Remove the Seal from the Orifice plate (As if removing a tyre from a wheel)

Fit the new Orifice plate into the Seal

Replace the Seal and Orifice plate assembly into the Hose tail nut, with the number on the Orifice plate facing outward so that it can be readily seen.

Screw the Hose tail nut onto the Body and tighten **hand tight only**, do not use tools.

High Pressure Injector and Foam Lance Instruction for assembly and use



The wash down system service point connection, (not shown), Injector inlet connection (1), Injector outlet connection (2) and the hose connection (3) must be compatible

To connect the system Quick Couplings together,

Slide the sleeve on the female coupling (1) or (3) back, away from the inlet, until the locking balls are exposed

Insert the male coupling (2) into the female coupling (1) and slide the female coupling sleeve forward so that the two couplings are locked together

To disconnect the system Quick Couplings,

Depressurise the hose system by closing the wash down system service point supply valve, point the lance towards the floor and pull the trigger on the washdown gun to allow pressurised water to discharge safely.

Slide the sleeve on the female coupling (1) back, away from the inlet, until the locking balls are exposed

Remove the male coupling (2) from the female coupling (1) and allow the female coupling sleeve to return.

Connecting the Dynamic Foam and Rinse Lance to the Wash Gun

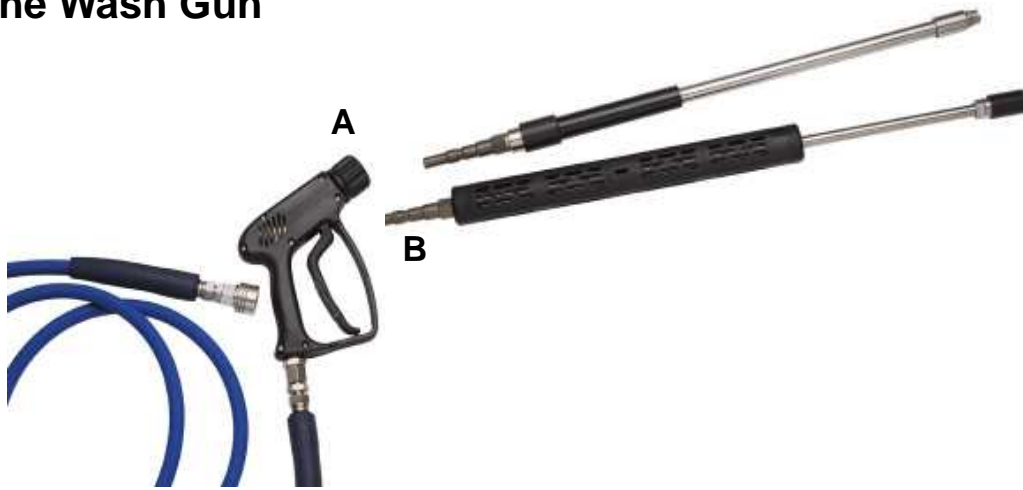

To connect the Lance to the Gun

Push the Gun Outlet Coupling (A) away from the Gun body, insert the Lance Spigot (B) into the Gun coupling (A) and pull the coupling closed.

Disconnect the lance

Push the Gun Outlet Coupling (A) away from the Gun body, remove the Lance Spigot (B) from the Gun coupling (A) and pull the coupling closed.

To Use the System

Connect the injector inlet Coupling (1) to the wash down service point as described above.

Connect the Hose Coupling (3) to the Injector Outlet Coupling (2) as described above.

Connect the Dynamic Lance Spigot (5) to the Wash Gun

As described above.

Put the chemical pick up tube (6) into the chemical drum.

The system is ready for use.

Turn the wash down service valve to the on position.

Direct the lance appropriately and pull the Gun Trigger, Apply the foam detergent as necessary.

When foaming operations are complete and rinsing operations are required, remove the Foam Lance and insert the Rinse Lance as described above and use appropriately.

Fixed Orifice Metering Valve

Part No 404-0120

Maintenance and Renewing the Seals

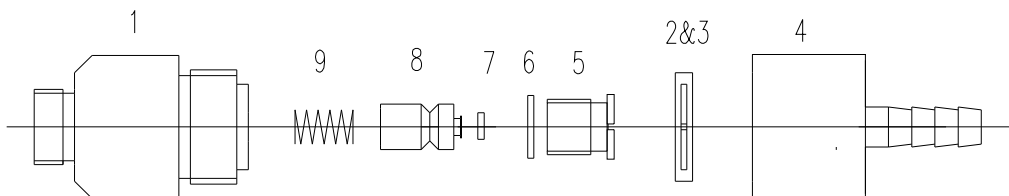

Unscrew the Hose tail nut(4) from the Body(1) taking care not to lose the Orifice plate and Seal assembly(2&3)

Using a flat blade screw driver, remove the valve Retaining Screw(5) by turning the screw anti-clockwise.

Remove the Valve Poppet(8) and Spring(9)

Using a small electrical screwdriver, or similar leverage, remove the Poppet Seal(7) and the Retaining Screw Seal(6).

Reassemble in reverse order using new wear parts

Standard Repair Kit part no 404 - 0182

- (7) 919-SE0160 Poppet Seal 70° upto 100 Bar
- (6) 919-SE0180 Retaining Screw Seal
- (9) 919-SP0160 Poppet Spring

Renew other parts only if damaged or lost

- (8) Poppet -part no 922-ME0160
- (5) Retaining screw- part no 922 ME0120
- (2) Orifice plate seal -part no 916-SE0150

Health and Safety notes

Always wear the appropriate personal protective equipment. Such as waterproof 'Cover all' garments, Wellington boots with toe and sole reinforcement. Head protection, Full face protection and a suitable Respiratory mask, when using High Pressure Jetting Equipment

High pressure fluid discharged to atmosphere through the high pressure injector will present a hazardous jet stream that may, on impingement, pierce waterproof gloves and cause flesh wounds.

The washdown system outlet valve must not be opened until the chemical injector outlet is connected to an applications system. Such as a washdown hose.



2011

CHESS-STAINLESS STEEL
CHEMICAL INJECTORS TYPE 109

Chess is a division of Central Hygiene Ltd

Central Hygiene Ltd
Red Hill House, Hope Street, Saltney, Chester.
CH4 8BU. England

Tel: 44 (0)1244 675066 Fax: 44 (0)1244 680129
www.central-hygiene.co.uk